

8

7

6

5

4

3

2

1

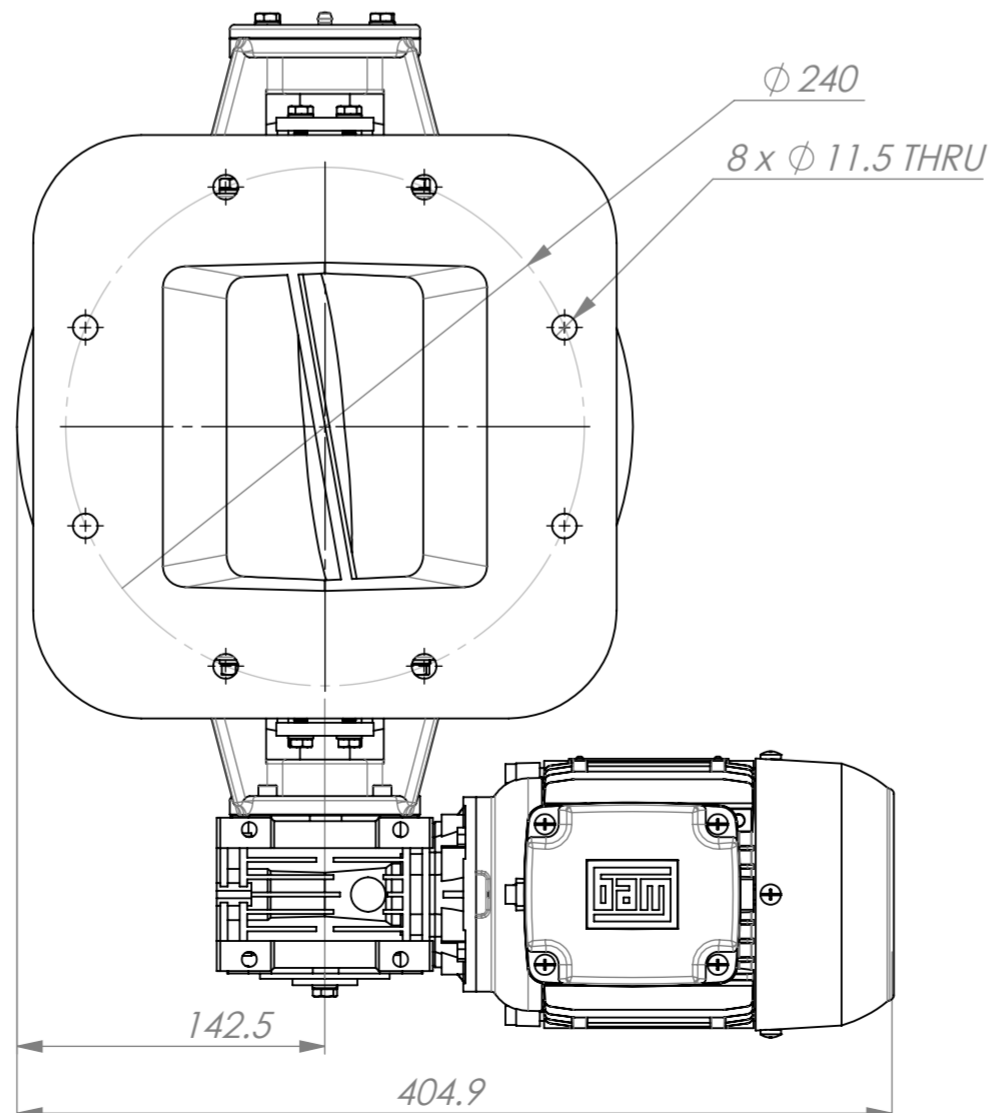
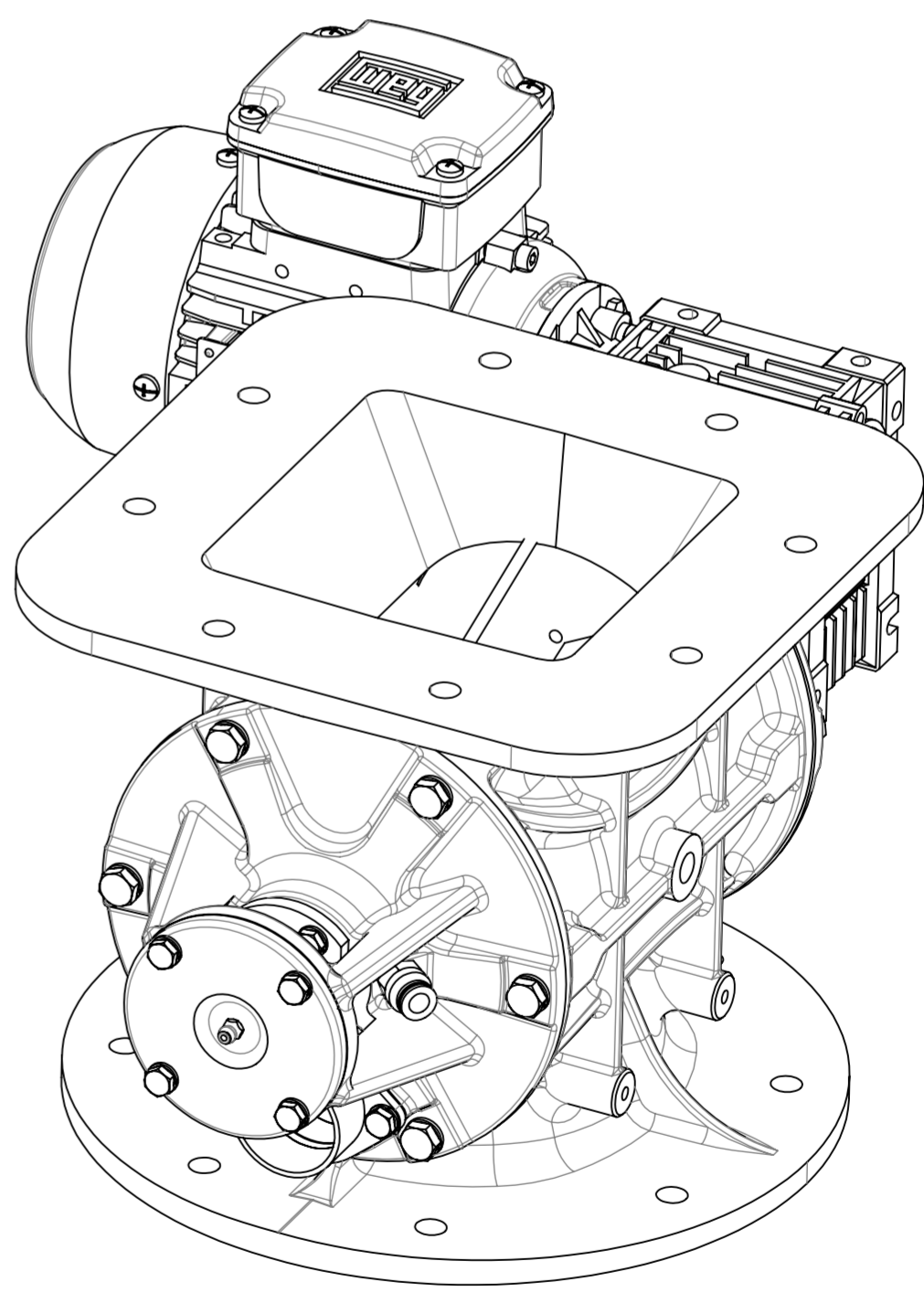
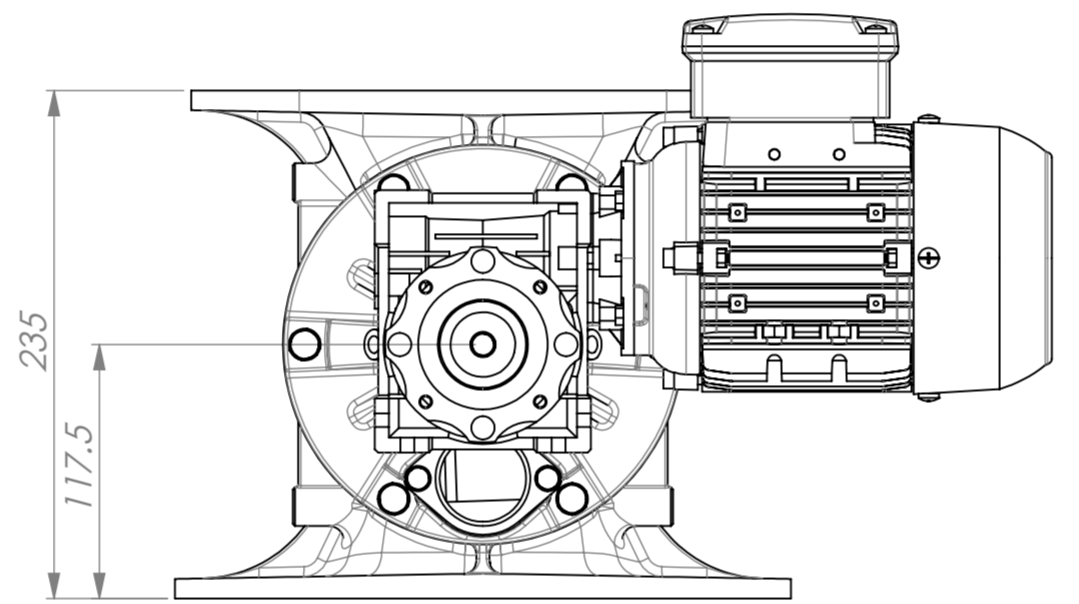
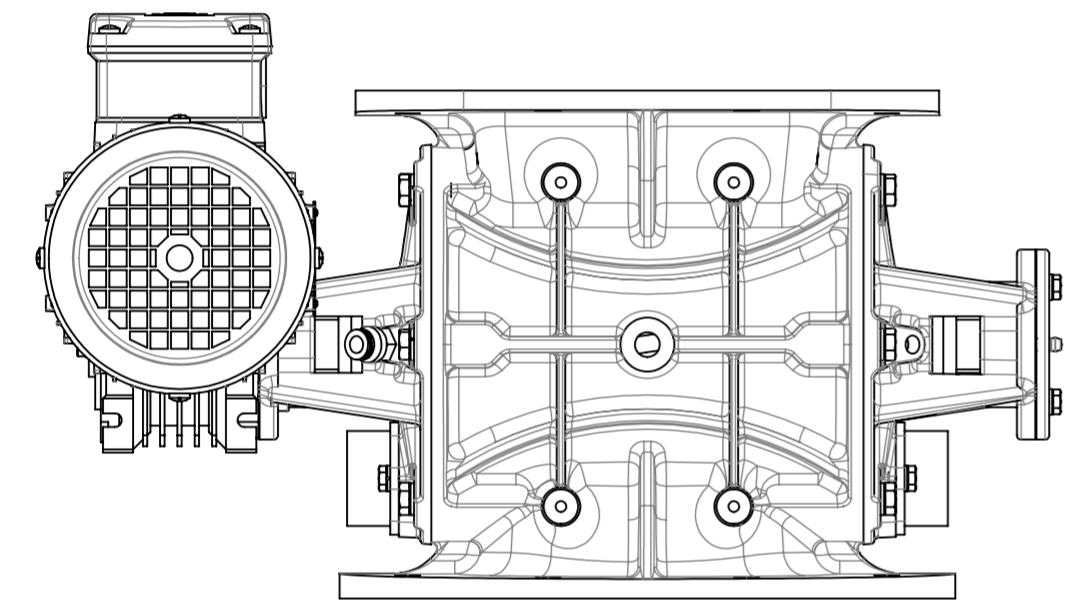
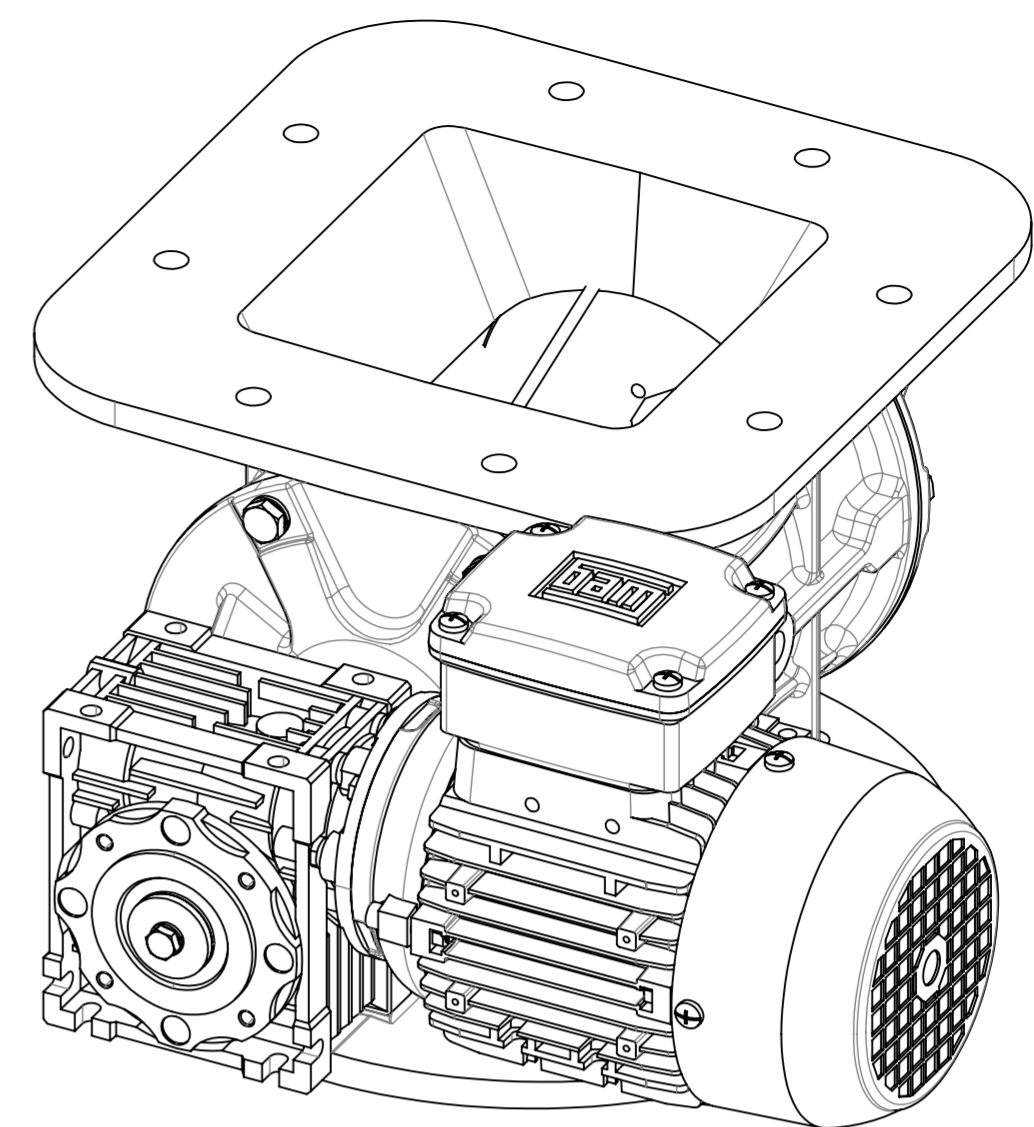
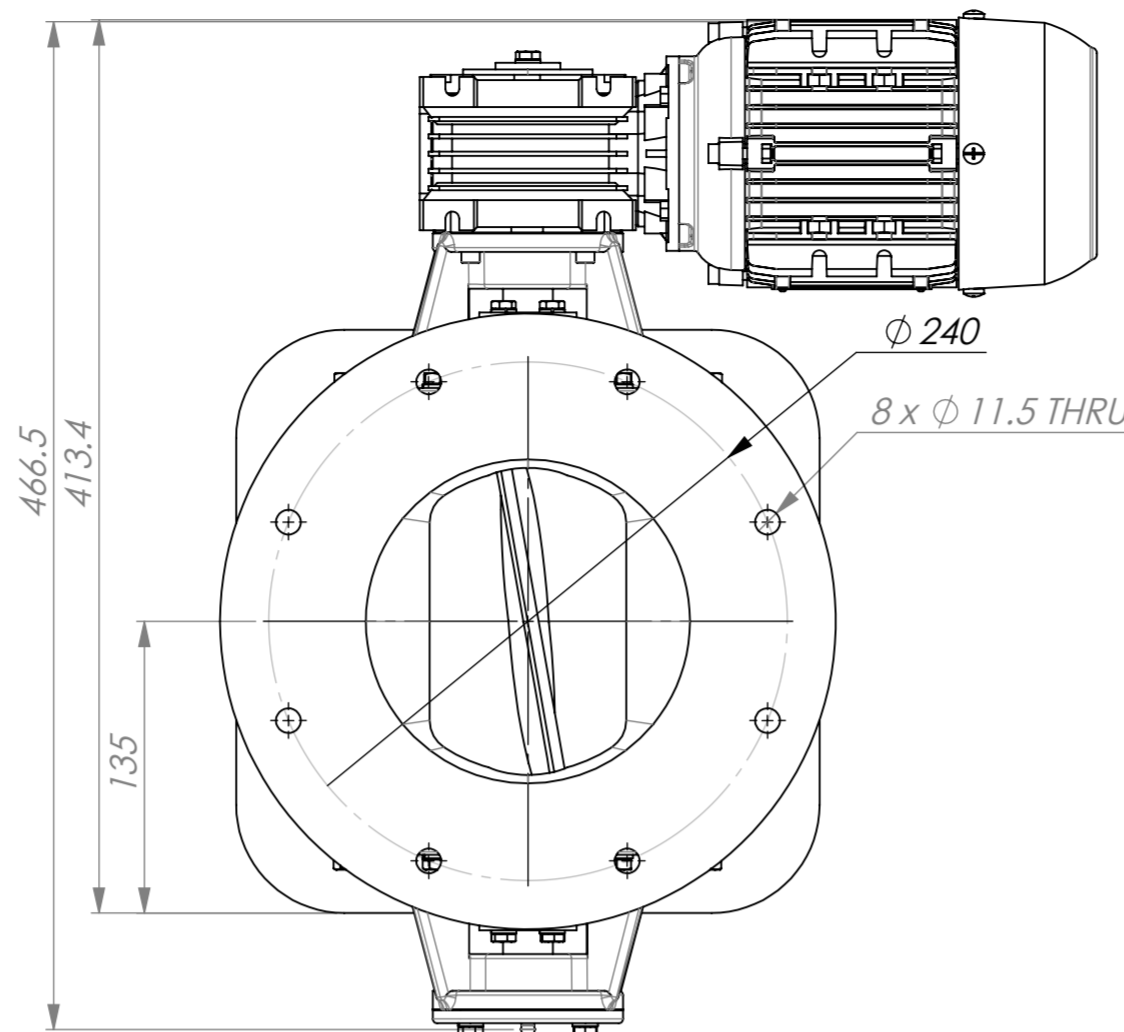

D

D

C

C

B

B

A

A

8

7

6

5

4

3

2

1

DASH NO.	NEXT ASSY.	USED ON APPLICATION

UNLESS OTHERWISE SPECIFIED 1. MARKING PER ISO 2842 2. BREAK ALL SHARP EDGES 0.1 X 45° OR 0.1R 3. DIMENSIONAL LIMITS APPLY AFTER PLATING	LAST DATUM LRT USED HEAT TREAT: FINISH SPEC. UNLESS OTHERWISE SPECIFIED DIMENSION ARE IN MILLIMETER	CUSTOMER: Padideh Kimia Co. DESIGN: ESGM Co. MET PRE: DESIGN APP: GROUP PRE: ENGR. APP: DRAWN: CHECKED: APPROVED:
--	---	---

APPLICABLE DOCUMENTS ABBREVIATIONS PER ISO-STD	HEAT TREATMENT FERROUS MATERIALS AS PER ISO 4885	GENERAL STANDARD AS PER MACHINING ISO 2768-1 mK LASER CUTTING ISO 2768-1 cK PLASMA CUTTING ISO 2768-1 vK GEOMETRICAL TOLERANCE ISO 2768-2 CASTING ISO 8852-C111 SURFACE ROUGHNESS ISO 1302 GALVANIZED COATING ISO 1461 Corrosion Protection ISO 8501-1:2004
---	--	---

PART NAME: 6" Advance Rotary Valve	PART NO.	SIZE A2	REFERENCE: SCALE: 1:3.5	FILE CODE:	Rev. 0
--	----------	-------------------	----------------------------	------------	------------------



SHEET 1 OF 1